

KIB Adhesive Sensors Instructions

Welcome to the RecPro tank adhesive sensors system. This set of sensors and the electric cord can be used to monitor your fresh, grey, and black water tanks. By following these simple installation instructions, you will have the ability to complete this project on your own*.

TOOLS REQUIRED:

- Tape measure
- Marker
- Garden hose

MARKING YOUR TANKS:

The first, and most important, step in this process is marking your tanks for sensor placement. You must follow the diagrams exactly, or the sensors could potentially provide false readings. There are separate diagrams for each of the tanks (which you will find at the end of this instruction sheet.) When marking your tanks remember:

1. Use a dark marker for clear white tanks (fresh and grey water) and a white or yellow marker for dark (black water) holding tanks.

2. When measuring out the locations for your sensors make clear lines where the sensors will be placed. Measure twice to make sure you have the proper placement. You will mark locations for:

- A. Full
- B. 2/3
- C. 1/3

PREPPING YOUR TANKS:

Whether you are installing a fresh, grey, or black water tank, the same preparation procedure should be followed. This will ensure that your tank is clear of debris and ready for use:

1. In an outdoor area or indoor area with excellent floor drainage, remove all the drain plugs (if applicable).
2. Use a hose to flush tanks thoroughly. Repeat this step a minimum of two times.
3. Tip tank up on edge to drain and allow to dry completely.

INSTALLING YOUR SENSORS:

After making sure the tank is clean, remove the paper backing and place the sensors on the marker lines.

ATTACHING THE WIRE EXTENSION:

Once you have placed your sensors (according to the provided diagram), connect the sensor wires to the wire extension by inserting the white connector at the end of the sensor wires into the white connector at the beginning of the wire extension, making sure that the flat ends of the prongs are on the same side for both of the connectors. Push until it snaps in place.

*IF YOU, FOR ANY REASON, HAVE QUESTIONS REGARDING THE INSTALLATION OF THIS SYSTEM, OR ABOUT HOOKING UP THE ELECTRICAL COMPONENTS, PLEASE CONSULT A PROFESSIONAL ELECTRICIAN, RV SHOP, OR CONTRACTOR EXPERIENCED WITH THESE TYPES OF INSTALLATIONS. *



806 S. Division St.
Bristol, IN 46507
(574) 848-0405
info@recpro.com

KIB Wire Extension/Control Panel Instructions

1. Make sure that you have all proper PPE (personal protective equipment) available when performing the installation.
2. Make sure all electrical items are shut off and disconnected at the source before installation
3. If you lack the skill to install this product, or have any uncertainty about installation, **STOP IMMEDIATELY**, and consult a professional.

Mounting the panel – There are four mounting screw holes on the panel to apply the hardware.

WIRE EXTENSION

Once you have placed your sensors (according to the provided diagram) connect the wire extension to one of the three connectors on the split pigtail, corresponding to the tank you are measuring (grey wire goes to grey water tank, brown wire goes to black water tank, and blue wire goes to fresh water tank). Once you have connected the wire extension to the split pigtail, connect the split pigtail to the control panel, making sure to snap the two connectors in place.

With the remaining wires:

- RED: Main wire-power
- WHITE: Main wire-ground
- LIGHT GRAY: Wire-power tank heating pad
- PURPLE: Wire-power water pump
- ORANGE: Wire-lead to LPG tank
- BLUE: Wire-lead to fresh water tank
- BROWN: Wire-lead to holding tank
- BLACK: Wire-lead to gray water tank
- BLUE AND WHITE: Wire-battery

Connect the control panel wires to the wires on the coordinating location, making sure all connections are complete with a wire nut and taped with electrical tape. Leave no bare wire exposed.

GENERAL DISCLAIMER FOR ALL

****THESE ARE GENERAL INSTALLATION INSTRUCTIONS AND BASIC DIAGRAMS. REC PRO (AND ALL ASSOCIATED COMPANIES) MAKE NO CLAIMS IN REGARD TO COMPATIBILITY WITH END-USER APPLICATIONS BY UTILIZING THIS INFORMATION, YOU (THE END USER AND (OR) INSTALLER) ARE EXPRESSLY HOLDING REC PRO HARMLESS FOR ANY PROPERTY DAMAGE, PERSONAL INJURY AND/OR DEATH, OR ANY OTHER LOSS OR DAMAGE THAT MAY RESULT FROM YOUR ACTIONS.**

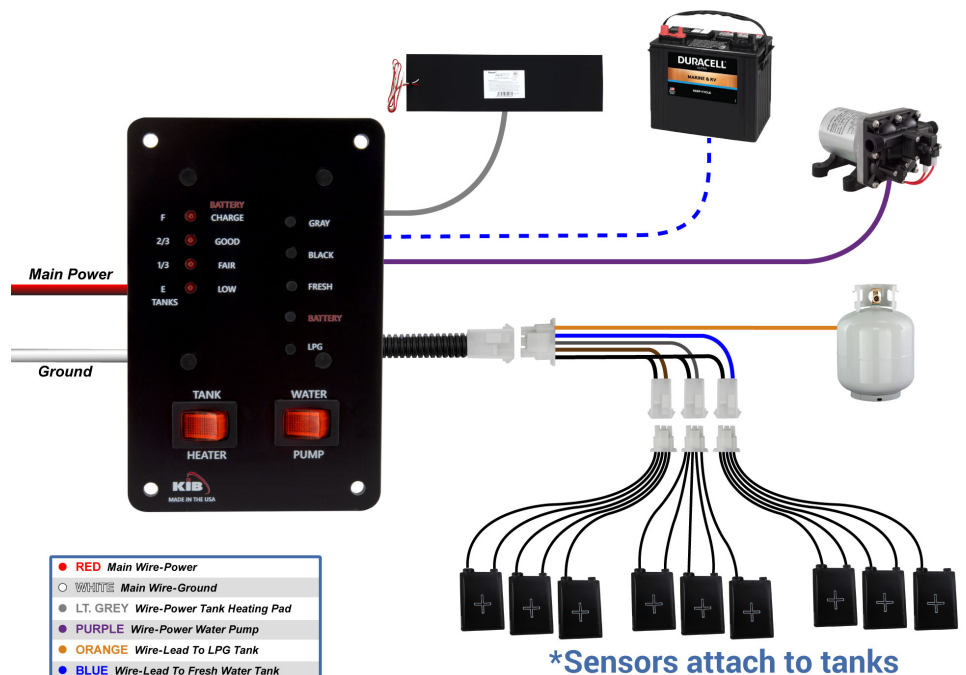

806 S. Division St.
Bristol, IN 46507
(574) 848-0405
info@recpro.com